

edited by:

Adriana Rossi, Pedro Cabezos, and Luca Cipriani

editor in chief  
deputy editor  
journal manager  
editorial board

Stefano Brusaporci  
Pamela Maiezza  
Alessandra Tata  
Mirco Cannella  
Giulia Flenghi  
Alfonso Forgione  
Alessia Garozzo  
Maria Laura Rossi  
Francesco Stilo  
Alessandra Tata  
Luca Vespasiano

scientific committee

(Italy) Stefano Bertocci, Carlo Bianchini, Massimiliano Campi, Mario Centofanti, Enrico Cicalò, Simonetta Ciranna, Antonella Di Luggo, Patrizia Falzone, Francesca Fatta, Andrea Giordano, Elena Ippoliti, Massimiliano Lo Turco, Alessandro Luigini, Francesco Maggio, Roberto Mingucci, Adriana Rossi, Daniele Rossi, Michele Russo, Rossella Salerno, Roberta Spallone, Ornella Zerlenga; (Spain) Pedro Manuel Cabezos, Teresa Gil-Piqueras, Pilar Chias Navarro, Pablo Rodriguez-Navarro; (UK-China) Eugene Ch'ng; (France) Livio De Luca; (Poland) Tomasz Jelenski; (Argentina) Mauro Chiarella; (Brazil) Altino Barbosa Caldeira, Ana Clara Mourão Moura; (New Zealand) Renata Jadresin-Milic.

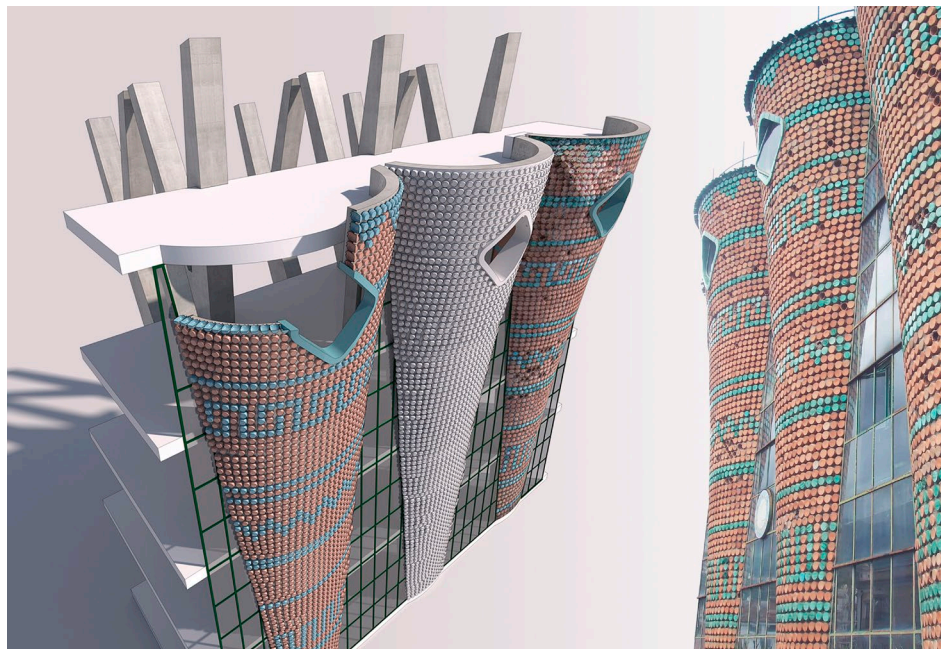

From laser scanner acquisition to HBim model from Solimene Factory (Vietri sul Mare Italy)  
[A.Rossi et.al. 2024.Between Memory and Reason: The Brick Wall, TEMA.Vol. 10, No. 1 (2024)  
Fig. 7 Autore Santiago Lillo]